



E-Ink Tablet Series
(with stylus)

Universal User Manual
V4.0

Onyx International Inc.

www.boox.com

Contents

1.Copyright Declaration	3
2.Safety Guide	4
3.Quick Start	6
4.System Functions	17
5.Library	24
6.NeoReader	33
7.Store	52
8.Notes	53
9.Storage	76
10. Apps	78
11.System Settings	86
12.Thank you for your support	94

1. Copyright Declaration

Onyx International Inc. reserves the right to make changes to the product specifications and contents contained in the Quick Start Guide and User Manual without prior notice.

1. All book images in this manual are for display only, not pre-installed books;
2. Due to differences in hardware and software versions, some features or interfaces on your BOOX may differ from those described in the manual. The actual functionality and interface are subject to the final products.
3. We are not responsible for the damage or loss of data in the equipment caused by human abnormal operation or unexpected circumstances, nor for other indirect losses caused thereby.

If you need to return to the factory for repair, please back up important data by yourself.

2.Safety Guide

Please read the following safety instructions before use. If you encounter any technical difficulties, please contact your BOOX retailer, or call the official after-sales hotline at 4008-400-014 or 4008-860-830 for assistance.



Fragile Screen Protection

The E-ink screen is very fragile. Please do not directly hit, squeeze, oppress the screen, or drop it from a high place onto a hard surface. If the display screen is broken, please stop using it and contact our customer service or other qualified professionals for replacement. Do not disassemble and replace it by yourself.



Qualified Accessories

Only batteries, chargers and other accessories that meet the safety standards of this equipment are allowed to be used. For details, please refer to the product specifications. Use of incompatible accessories will result in damage to the device at your own risk.



Keep away from strong magnets\static electricity

Please keep away from strong magnetic and electrostatic environment to avoid abnormal writing on the electromagnetic screen or damage to other electronic parts.



Keep away from liquids

This device is not waterproof. Do not expose it to a humid environment or use it in the rain. Please keep it away from any corrosive liquids.



Do not dismantle the device

The battery of this device cannot be replaced. Please do not disassemble it by yourself to avoid damage to the structure or screen.



Using environment

The environment temperature range of using this device is 0 ° C-50 ° C. Please do not use it continuously in high temperature or low temperature environment.

3.Quick Start

3.1 Home Screen

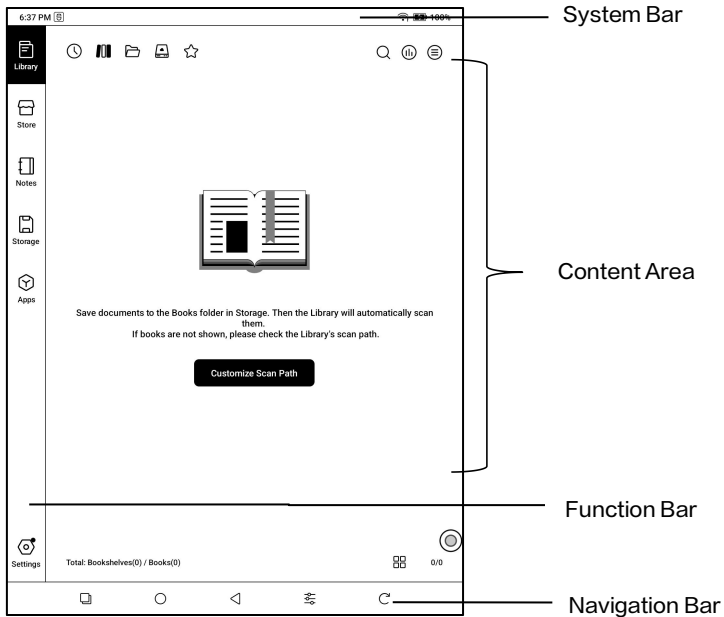

Control Center

Pull down from the right side of the System Bar or tap to expand.

The Centre includes some frequently used functions such as Volume settings, Front Light adjustment (some models do not support this).

Tap the “Edit” icon in the top right corner to add/remove/ reorganize function tiles.

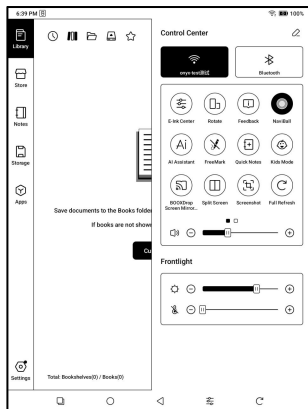

Notification Center

Pull down from the left side of the System Bar or tap to expand.

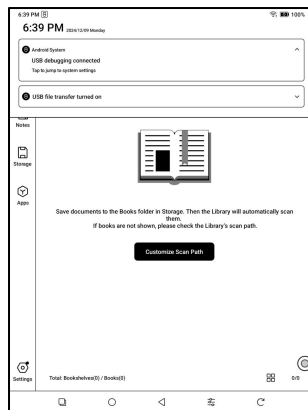

3.2 E-Ink Center (App Optimization)

It can be called from the Control Centre or swiping up from the bottom.

This function is mainly used to optimize the display effect of third-party apps.

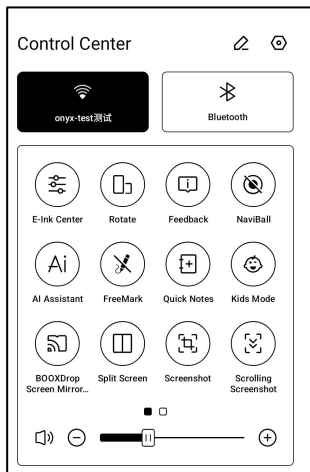

Refresh Modes

You can preset different refresh modes for different apps, or change later.

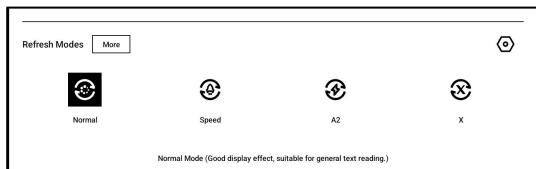

Normal(Default): Good display effect, suitable for ordinary text reading.

Speed: Slight ghosting and aliasing effect, suitable for thumbing through eBooks with text and images.

A2: Slightly heavier ghosting and aliasing effect, suitable for browsing images and text by quick sliding.

X(Only some models support): Heaviest ghosting and aliasing effect accompanying detail loss, suitable for browsing websites and video playback.

*Refresh Modes for NoteAir3C

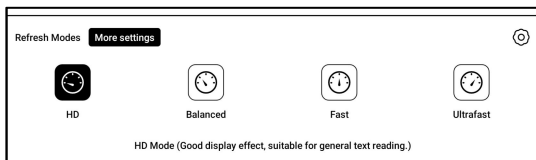

HD: Good display effect, suitable for general text reading.

Balanced: Heavier ghosting, suitable for quickly skimming through images and text.

Fast: Heavy detail loss, suitable for browsing webpages.

Ultrafast: Heavier detail loss, suitable for playing videos.

Dark Color Enhancement (Black and White Displays)

This function turns darker colors to black and is generally used for enhancing foreground colors, or light-colored pages, such as colorful icons, and low-quality scanned PDFs.

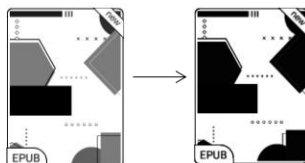

Light Color Filter (Black and White Displays)

This function turns light page colors to white and is normally used to whiten the background colors.

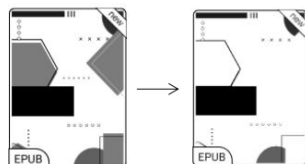

Color Mode (Color Displays)

There are 2 preset modes and 1 option to customize.

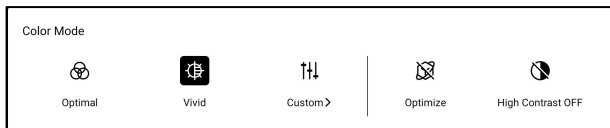

Optimal: Moderate color vibrancy and brightness with well-balanced tones.

Vivid: High vibrancy and brightness, with more saturated colors

Custom: Allow users to adjust vibrancy and brightness to their preference

High Contrast

When an App is using Balanced/Fast/Ultra-fast refresh modes (non-HD modes), some interface lines or colors may appear weakened. You can enable “High Contrast” on the E Ink panel to enhance page display quality.

More Settings

Customize more optimization settings for a better user experience by going to E Ink Center/ App Optimization or long-press an app' s icon to choose “ Optimize” .

Display

DPI Setting: Adjust the overall size of the app interface, with a recommended range of 280–350.

Use app' s original DPI: For some apps, reducing the DPI to the minimum value may still result in an edge cut-off. In such cases, you can restore to the app' s original DPI value.

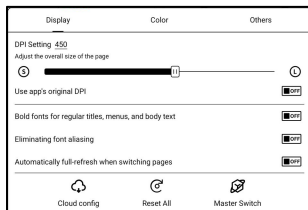

Anti-aliasing: Make the text edge sharper

Cloud Optimization: Some apps have been optimized for better performance. Obtain the optimization with just one click after connecting to the internet.

Reset All: All optimization settings will be reset.

Master Switch: The main switch. After it is turned off, some optimization effects will be canceled, but the configuration will not be reset.

Color

Add strokes to text

Some text may be invisible due to the background bleach. Add strokes to text can make the text visible again. Recommended value: 1.

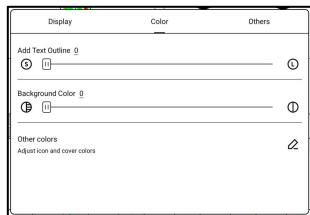

Background Color

This is to bleach a large area of the background color. It is recommended to use this setting together with text enhancement and Icon Colors. Otherwise, the text and small icons on the background will not be visible.

Icon Color

Generally, this is to darken the colors of some small colorful icons in the menu.

Cover Color

Generally, this is to darken the colors of large cover-style icons.

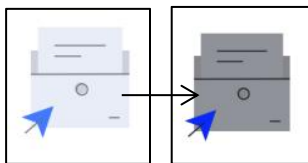

Webpage Text Size

This is for the embedded WebView interface. When the DPI adjustment is invalid, you can try to adjust the font size of the webpage

Webpage Text Color

When bleaching does not work, you can try to adjust the webpage colors.

Embolden Webpage Text

When some fonts cannot be emboldened, you can try to embolden the webpage text.

Others

Stay active in the background

This is for the apps that are continuously running in the background, such as Alarms, Notifications, Download. You can stop the apps running.

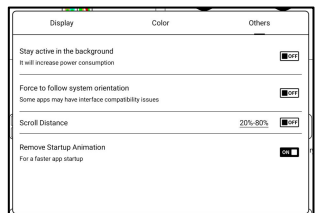

Force to follow system orientation

Some APPs lock the direction. When the system rotates, if the APP cannot follow the rotation, forced rotation can be used; Forced rotation may cause some interfaces to fail to display normally. For such APP, it is recommended to turn off forced rotation and use the original direction.

Scrolling Distance

You can go to the Scrolling Button Setting page from App Management (Tap the Menu bar on the upper right corner on the Apps homepage) or Navigation Ball settings.

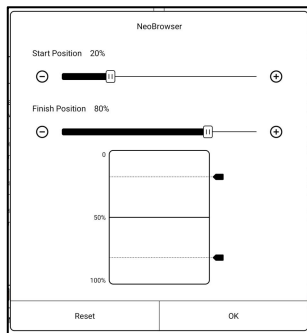

When enabled in third-party apps, the Scrolling Buttons can be used to turn pages. Based on the actual situation of the page, you can set the required starting and ending positions to avoid inconsistent or partially duplicated content after turning a page.

It is recommended to set the starting and ending positions between 15% and 90% of the screen. A range that is too large may make it difficult to turn pages effectively while a range that is too small may result in excessive repeated content.

Handwriting (Only support some Apps)

Optimize handwriting speed specially for apps that support handwriting function.

Refresh time after lifting stylus:

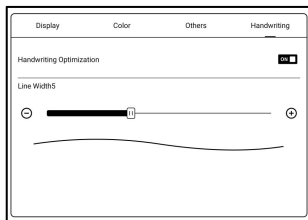

The handwriting will be refreshed in a set time after you stop writing.

When refreshing handwriting is in progress, you cannot continue writing. You can continue writing after the refreshing is done.

If you want less interruption by the refreshing, you can set the refreshing frequency longer.

You are recommended to disable hand touch to reduce accidental touch on the canvas to cause problems.

4. System Functions

4.1 Screen Cast

4.1.1 This feature supports Windows 10 or above. It does not support Win 7/XP and MacBook.

4.1.2 Please make sure your computer supports the Screen Cast function. You can check it in the computer system: System / Projecting to this PC

Please be aware that there are 4 settings that will affect the results of searching the computer on your BOOX and the confirmation of connection request.

The computer supports
Screen Cast

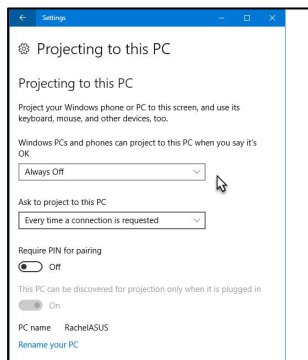

The computer does not support Miracast /Screen Cast

4.1.3 Please make sure that your computer and BOOX are connected to the same wireless network.

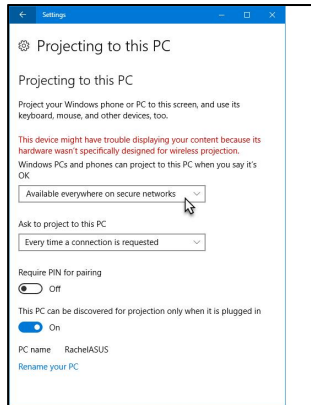

If your desktop computer connects Wi-Fi via Wireless Network Card, please check whether the step2 is supported. Some computer configuration and wireless network cards do not support this function.

4.1.4 On your BOOX, select Screen Cast from drop-down Control Center. Then the automatic search will start. The computer name will be shown when found.

4.1.5 Select the found computer in the search window. If there are multiple computers, select the computer that you want to project to from the list.

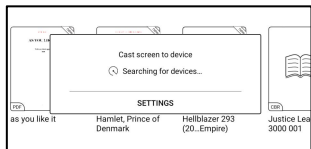

4.1.6 After you select the computer that you want to project to, your computer will pop up a notice to ask whether to accept the projecting request.

4.1.7 After you accept it, your BOOX and computer will automatically connect to each other. And the Screen Cast is successful.

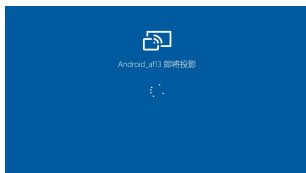

If the "Unable to view protected content on this device" appears on the screen, the connection may be unsuccessful. Please disconnect the device, and request the Screen Cast connection again.



4.1.8 When your BOOX and computer are connected, please tap Screen Cast again from Control Center, then select "Disconnect". Your computer cannot disconnect the connection.

If your computer support Screen Cast but cannot receive the request, please restart your computer and try to connect again. Please also check whether your computer's setting is to reject the request. (See Step2).

4.2 Split Screen

When an app is open, choose Split Screen from Control Center to initiate the function. The Split Screen supports docs, Notes, and other apps. The Split Screen cannot be initiated from system interface.

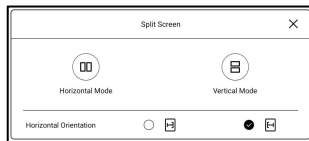

Note: Whether an app supports Split Screen is subject to the app itself. If the app does not support Split Screen, please get in touch with the developer.

In Split-Screen mode, the newly opened app is the secondary screen. You can choose to swap sides and exit the Split Screen mode.

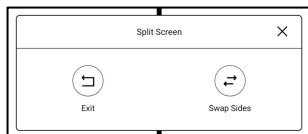

4.3 Ai Assistant

You can enable this feature from the [Control Centre], or from the app list, or from NaviBall.

Each topic allows for multiple rounds of dialogue.

There are different AI models available. You can select the model you prefer from the dropdown menu located on the top right corner.



All responses are generated by AI and are for reference only.

4.4 BOOXDrop Screen Mirroring

You can enable it from the [Control Centre]

Within the same local area network, please enter the specified URL link in the browser of the device you want to cast to or scan the QR code for fast screen mirroring.

This feature currently only supports screen mirroring and does not support reverse control of the BOOX device.

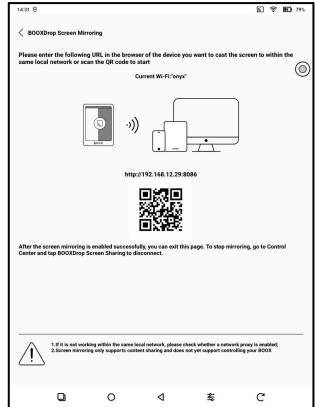

4.5 FreeMark

You can enable it from Control Center

When you turn pages, current screen with handwritten notes will be automatically saved in JPG format. You can also save the content by tapping the Save icon on the toolbar.

Tap the Hamburger icon to check all saved images with notes. The default save path is /Picture/Onyx/(APP Name) . Tap Current Path to customize the saving path.

Only apply to certain apps that support page-turn buttons. In Handwriting mode, you can swipe to turn pages. For apps that do not support “swipe to turn pages”, please switch to Application Mode first, then turn pages.

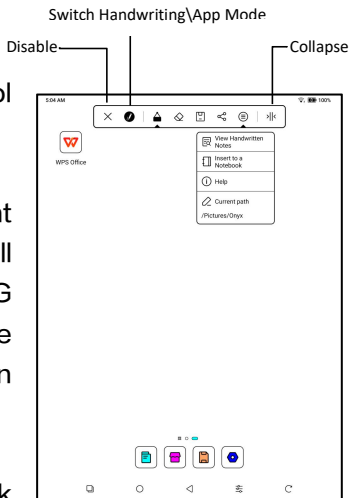

5. Library

The Library allows you to switch between Recent, Bookshelves, Storage, Favorites, and Cloud Storage.

5.1 Library (Default)

Automatically scan all supported files under specified saving paths.

5.2 Storage

The documents are displayed by the scan path set in the Library settings. You can choose this option if you have already organized and archived books by folders in Storage.

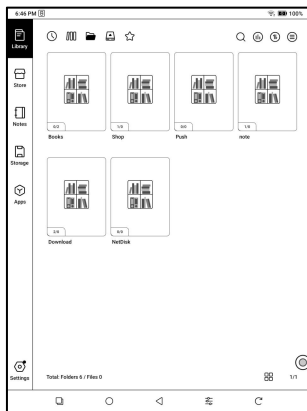

Library List Settings

You can customize the number and order of library list icons in the dropdown menu ‘More’ – Library Settings – Library List Settings.”

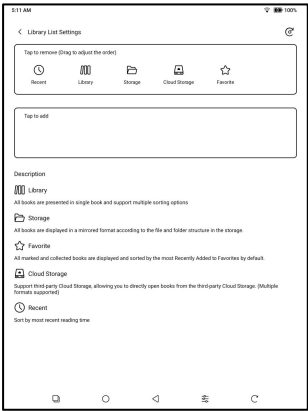

5.3 Filter and Sort

The default options are All books for Filter and Recently Read (Recent → Older) for Sort

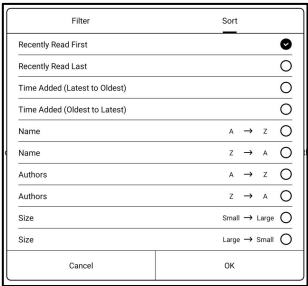
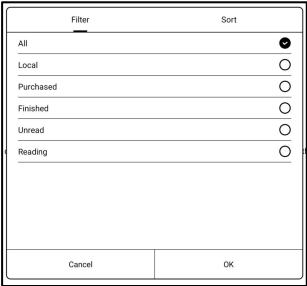

5.4 Cloud Storage

You can bind third-party Cloud Storage services and notes app accounts, then download documents from Cloud Storage or upload local documents. Additionally, you can export document's annotation, highlight, and handwritten notes to apps.

After embedding data to PDF documents, you can upload the PDF documents back to the original folder in the Cloud Storage. Other formats currently do not support this feature.

To sync reading data, please log in to your ONYX Account.

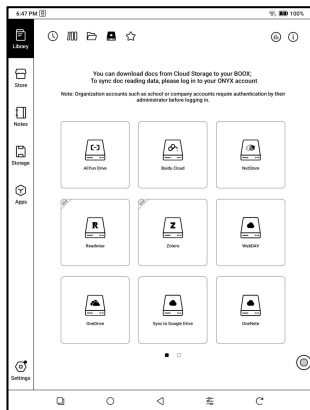

Sub-bookshelf for Cloud Storage

After a Cloud Storage account is bound, a bookshelf will be automatically created in the Library when you download books from the Cloud Storage for the first time.



All books downloaded from the Cloud Storage will be automatically placed in this bookshelf for easy access and reading.

The bookshelf name can be modified without affecting the automatic categorization of books. If the bookshelf is deleted, associated books will be moved to the root directory of the Library.

Copy to Cloud Storage

You can manually upload local books on your BOOX to specific Cloud Storage. Long press the book cover in the Storage or Library, then select Copy to Cloud Storage.

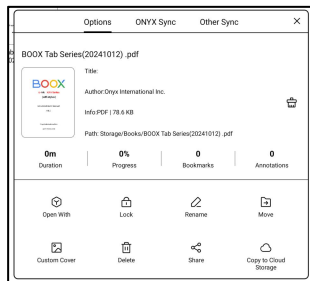

Auto-upload is currently not supported

5.5 Bind WebDAV

Please refer to the binding introduction of each Cloud Storage because different Cloud Storage providers may use different login methods.

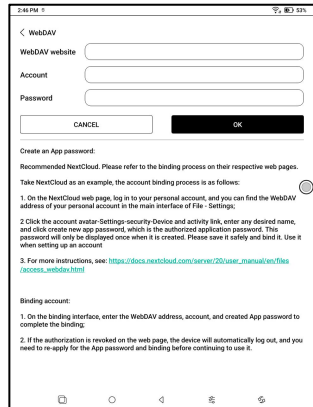

5.6 Book Property

Long press a book cover to check book-related information, including title, author, format, size, reading progress, book details, Open with, Lock, Rename, Move, Custom Cover, Delete, Share and Copy to Cloud Storage.

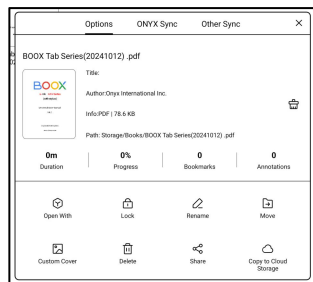

Clear settings

You can clear password, reading data, cache, and book cover.

Clear password default settings

Only clear the default settings of locked documents or documents with their own passwords, and will not clear the relevant passwords.

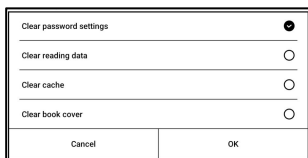

Clear password settings	
Clear reading data	<input type="radio"/>
Clear cache	<input type="radio"/>
Clear book cover	<input type="radio"/>
Cancel	OK

Clear reading data

All personal data of the selected book will be cleared. The data cannot be recovered after being cleared.

Please perform this action carefully!

Lock

Add lock to document (reading passwords) to protect personal reading data.

The password is used to open books in NeoReader. When the documents are exported or copied to other devices or other apps, the password will not be valid anymore.

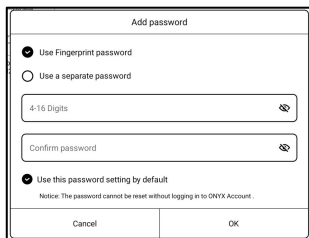

The screenshot shows a dialog box titled "Add password". It contains two radio button options: "Use Fingerprint password" (which is selected) and "Use a separate password". Below these are two text input fields: the first is labeled "4-16 Digits" and the second is labeled "Confirm password". Both fields have a small eye icon to the right, indicating a toggle for password visibility. At the bottom, there is a radio button option "Use this password setting by default" (which is also selected). Below this option is a small notice: "Notice: The password cannot be reset without logging in to ONYX Account." At the very bottom of the dialog are two buttons: "Cancel" and "OK".

The digital password only supports setting one password. After setting the digital password for the first time, you do not need to set it again if you use the digital password for other documents. You only need to add locks to other documents.

The reading password cannot be retrieved. If you forget your reading password, you can only reset the password through Onyx Account (only Mobile phone and Email login methods supported).

If you use this password by default, you can add password directly to other documents after setting it for the first time. In this case, you do not need choose to add locks every time.

5.7 ONYX Sync

You can sync reading data to the ONYX Account to view reading progress and other reading data across devices.

The Sync Switch is enabled by default, but you can turn it off if no documents need to be synced. To disable sync for individual documents, please long-press the book cover to go to the ONYX Sync setting page and turn off the Sync Switch.

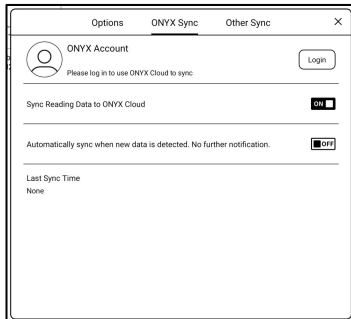

Note: Only reading data can be synced. Users must manually add the source documents to the same path on different devices for sync to work.

5.8 Other Sync

You can export reading data to a linked third-party cloud storage account. The Cloud Storage that does not support this feature will not appear in the list here.

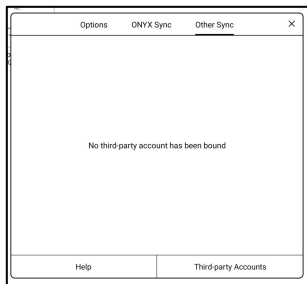

5.9 Reading Statistics

This summarizes your personal reading statistics, including Today's Reading Time, Read Books, Finished Books, Total Reading Time, Marks and Annotations.

If you do not want to use reading statistics, you can turn it off from Library Settings. After it is off, the reading statistics icon in the Library will not show anymore

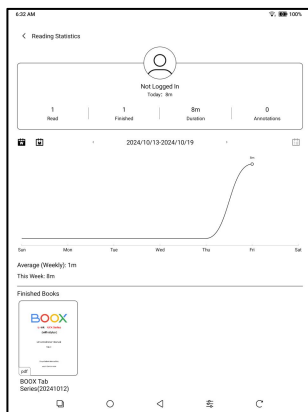

5.10 Library Settings

Here you can set the ONYX Sync Account, adjust library list settings. Use title names for Library books, enable Reading Statistics, and set auto-scan path.

The preset scan paths include folders Books and Shops in the Storage.

You can customize the scan path and choose to auto-scan the specified path.

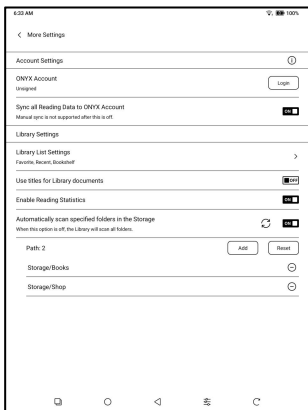

6. NeoReader

Tap the center of the screen to bring up the reading menu. You can switch between multiple documents, and select related functions.

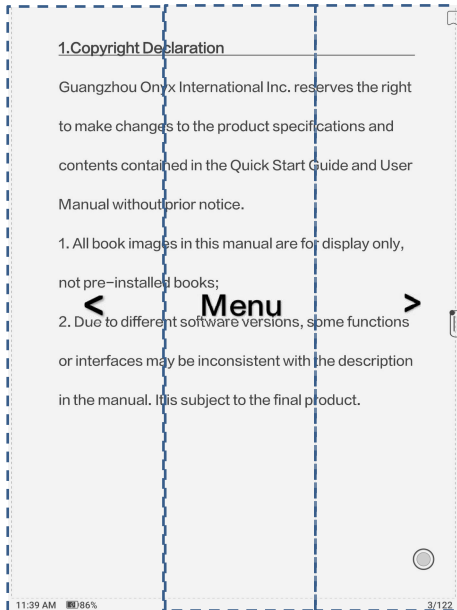

6.1 Floating Toolbar

By default, the Floating Toolbar is collapsed to the right edge. When it is expanded, long press the Toolbar to drag it to anywhere you want on the screen. It can be collapsed to the sides to avoid covering text during reading. You can customize the Floating Toolbar and add your frequently used tool icons to the toolbar.

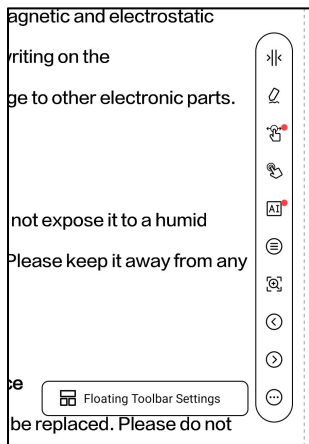

When Zoom or Comic Mode / Article Mode is in use on a PDF document, the Floating Toolbar will automatically add the “Drag” and “Reset” icons. To avoid accidental touches, the dragging function is disabled by default. When text is selected, the pre-installed dictionary will be popped up for word lookup, with the ONYX dictionary set as the default option.

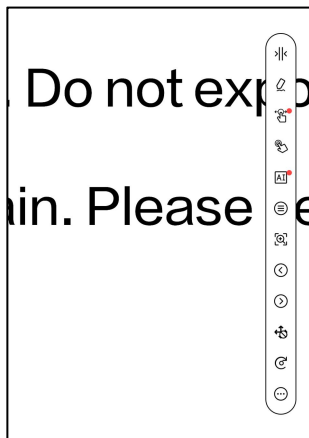

Tap on a blank area to exit the dictionary interface. If having installed third-party dictionaries, you can choose your desired dictionary from the dropdown list in the dictionary.

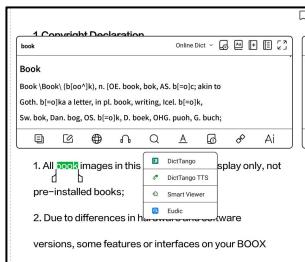

6.2 Gestures

For dual-touch models, you can disable gesture operations in certain areas of the screen while using the stylus, reducing interference from accidental touches during handwriting.

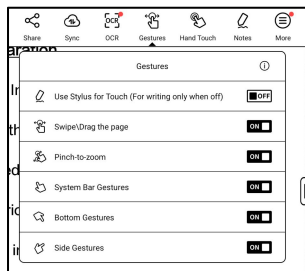

6.3 OCR

Only support images on formats including PDF、CBR、CBZ、DJVU、PNG.

Selecting the right layout (horizontal or vertical layout) can improve recognition accuracy.

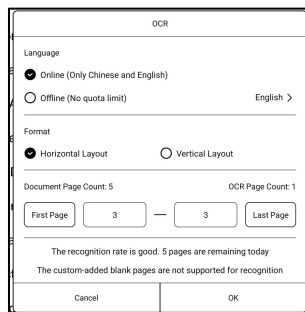

After recognition, long press any text to add marks or look up dictionaries.

Check all recognized pages from Contents/Bookmarks where you can quickly locate and jump to the relevant pages. Tap the OCR icon on the upper right corner to clear OCR content.

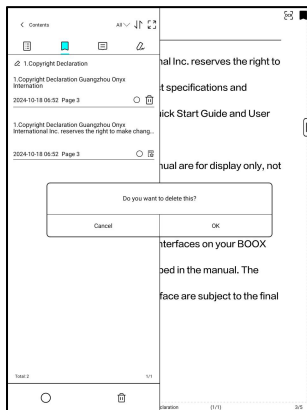

6.4 Handwriting Toolbar

The Handwriting Toolbar is floating on the screen. You can long-press it and drag it on the screen freely.

You can customize the toolbar and add your frequently used icons to it.

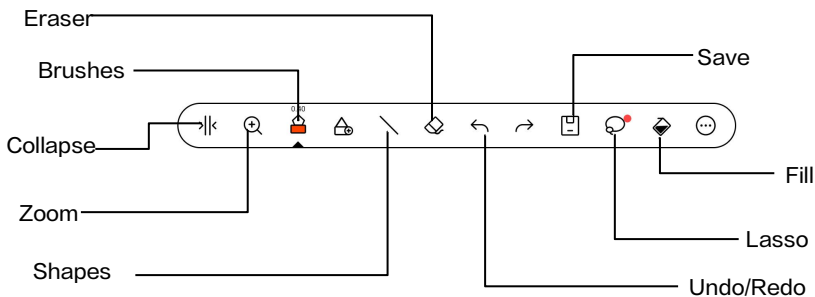

6.5 Smart Scribe

You can convert hand-drawn shapes into standard ones, add marks to selected content, erase unwanted content, or convert them into text.

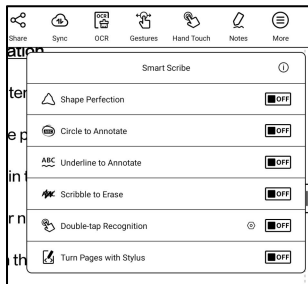

Shape Perfection

Pause for 1 second on the screen after completing the shape drawing, then lift the stylus after the shape is perfected.

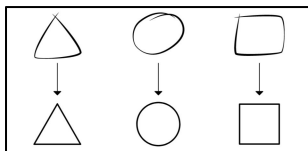

Circle to Annotate

Drawing underlines or circles over text will be directly converted into highlights.

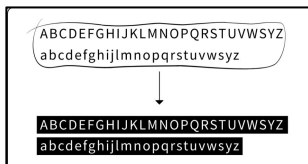

Scribble to Erase

Quickly draw vertical lines over any handwritten content, the content will be erased after you lift the stylus. It is not applicable to a blank area.

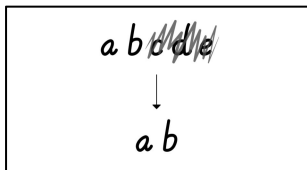

Double-tap Recognition

For handwritten notes and drawn shapes, double-tap onto the notes, which will be converted to printed text and standard shapes.

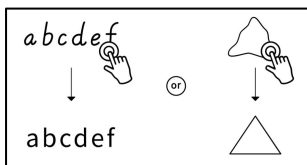

Turn pages with stylus

When palm rejection is enabled, you can enable this feature from Settings-Handwriting Recognition Setting. After it is enabled, you can turn pages by tapping the lower left and right corners using your stylus.

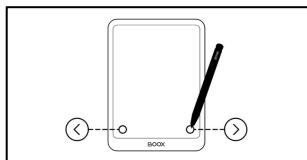

6.6 Reading Menu at the bottom (PDF)

The menu includes Contents, Progress, Style, Contrast, Navigation, and Split View.

Contents

This section includes TOC, Bookmarks, Annotations, and Handwriting.

TOC

Supports a 3-level structure. The current page is underlined in the TOC. Tap each content to jump to the corresponding page. Tap any area outside of the Contents interface to exit.

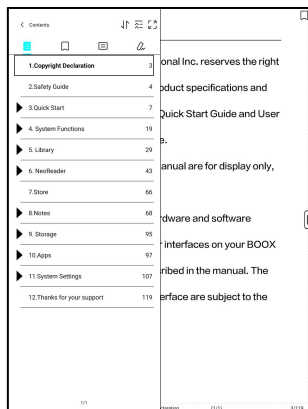

Bookmarks

When reading a book, you can tap the Bookmark icon on the upper right corner to bookmark the current page. Tap the icon again if you want to un-bookmark the page.

Check all bookmarks at Contents/Bookmark. Tap each bookmark to jump to the corresponding page. You can also delete bookmarks here.

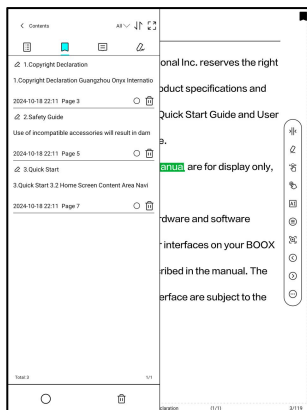

Annotations

All highlighted, underlined, and annotated contents are shown in Contents/Annotations. You can check, edit, and delete all relevant content here.

Tap each content to jump to the corresponding page. All contents under Annotations can be exported in txt format. The default saving path for the exported contents is Storage/ note/ a file with the same name as the original document.

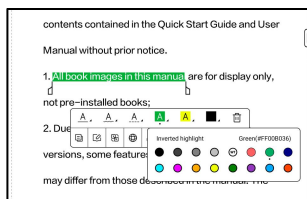

Handwriting

All pages with handwritten notes are shown in Contents/Handwriting. You can check and delete the relevant pages. Tap each page thumbnail icon to jump to the corresponding page.

All pages with handwritten notes can be exported in PNG images. The default saving path for the exported contents is Storage/ note/ a file with the same name as the original document.

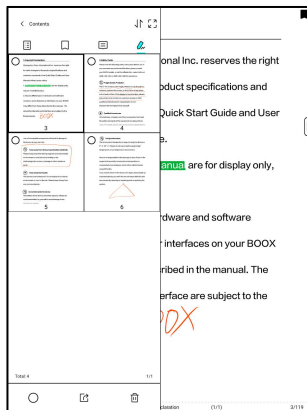

Progress

Here it shows a chapter name of the current document (if no chapter name, the document name will be shown), progressing page number, Previous/Next chapter, page number, Automatic Page–turns, Redo and Undo, etc.



Add Blank Page in PDF

When reading a PDF doc, you can add a blank page by going to Progress/Blank Page. This makes it convenient to add more notes. When adding a blank page, you can choose whether to switch to double-page mode automatically for side-by-side referencing.

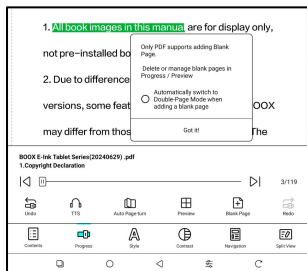

You can view and manage the added blank pages from Progress / Preview. The original pages are not supported for deleting and moving.

To delete an added blank page, tap the Delete icon in the top right corner of the page, or go to Progress / Preview to manage pages in bulk.

The original pages are not supported for deleting and moving.

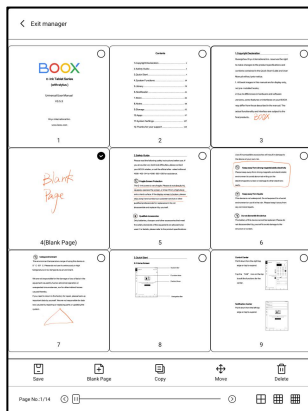

Style

Page Display: You can switch between Single-page View, Scrolling View, LTR (Dual-page Mode 1), and RTL (Dual-page Mode 2)

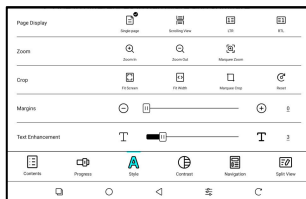

Zoom: You can zoom in/out the whole page, zoom in the marquee area, or pinch-to-zoom any area you want.

Crop: Fit Screen (crop all margins); Fit Width (Crop left and right margins); Marquee Crop(Manually select crop area)

Margin: This is for the margin you want to keep for automatic crop. You can adjust it to the size you want.

In zoom-in status, when the zoomed-in page exceeds the screen area, you can drag the page around to check different areas. A single tap only turns sub-pages. Tap the Virtual Buttons to turn the whole page.

Contrast

Bold: only embolden text in PDF

Sharpen Img: Make blur image sharper

Watermark Bleaching: Bleach the light-color images or background on the page

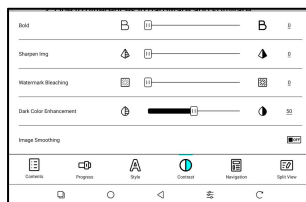

Dark Color Enhancement: Adjust for the whole page or only the text, making the display darker.

Image Smoothing: Optimize the display effect of pictures with gradient colors.

Navigation

This section includes Comic Mode, Article Mode, Reflow, and more custom settings. You can crop a scanned PDF, divide it into columns, and set its browsing orders.

Comic Mode: After pages are divided, all margins are automatically cropped to maximize the display area.

Article Mode: After pages are divided, all margins are preserved, making it easy to add handwritten notes.

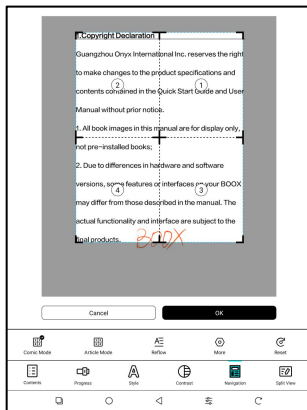

Navigation / More

Crop: You can manually crop the blank margin in either single-page or dual-page modes.

Columns: Divide the current doc into different columns

Direction: Set the reading order of the divided columns

Auto-Crop Margins: you can customize the option to retain or remove the margins all around.

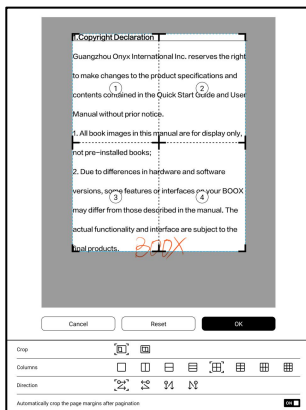

Reflow

Only apply to PDF\DJVU\CBR\CBZ in scanned version and text-based version.

Scanned Version

You can adjust Text Direction, Spacing, Alignment, Font Size, Columns, Tilting Correction.

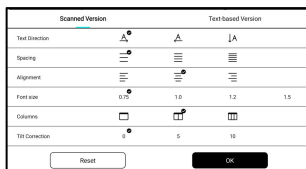

Text-based version

Apply to digital or OCR'd PDF. After being reflowed, the document can use flow-document functions.

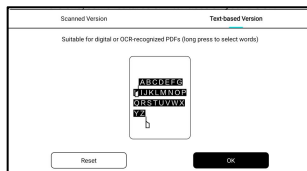

Split View

You can choose to split horizontally or vertically. There are multiple splitting options available:

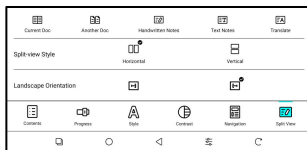

Current Doc: Open the current Doc only

Another Doc: Open the current Doc + a different doc

Handwritten Notes: Open current Doc + Handwritten Notes

Text Notes: Open the current Doc + Text Notes

Translate: Open the current Doc + Full-Text Translate

For the notes created with Split View, you can view them under Reading Notes in the Notes app. Those notes are linked with specific documents. If you need to use an independent notebook for the notes, you can use the system-wide Split Screen function to open NeoReader and the Notes app at the same time.

Detect Data (PDF Embedded Data)

When a new PDF document is opened, the system will automatically check whether the document contains handwritten data and if there is historical data on the device for the document.

(For example, if a document was deleted and then reimported with the same name, historical data might still exist on the device)

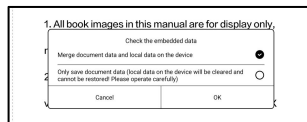
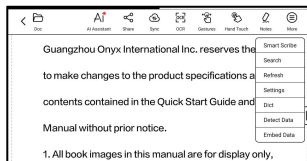

If the document is already open but the device is performing other actions or some data is missing in automatic detection, you can manually enable the detection feature.

If both document data and local data are available, please choose to keep the document data and the local data will be deleted. The deleted local data cannot be recovered. Please perform this action cautiously.

Embed Data

When a PDF document is exited, the handwritten data will automatically be embedded. The embedded data will follow the document and can be viewed with other PDF software. When the PDF document is in use, you can also embed data manually by popping out Reading Menu >More > Embed Data.

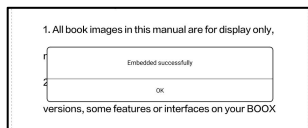

6.7 Reading Menu at the bottom (Free Flow Documents)

The menu includes Contents, Progress, Style, Split View, Refresh Settings.

V3 Engine

The menu includes Contents, Progress, Format, Contrast, and Split View and supports free-flow formats such as ePub\mobi\azw3\txt\word\jeb\html

Progress

When opening a document for the first time, or after adjusting font, size, spacing, or other style settings, the document will be re-paginated. You can view the pagination progress in the Menu > Progress. You will only be able to drag the progress bar to jump between pages once the progress bar has fully loaded.



Style

The original appearance of the document is used by default. There are multiple preset appearances available to choose from. You can apply different appearances to different documents for different styling. A modified style will be marked with an asterisk (*) in the top right corner.

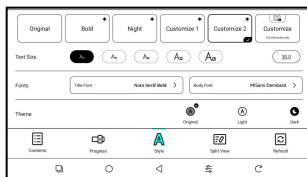

Custom Appearance

Tap the currently applied appearance to enter a custom interface, where you can modify various document settings, including font, size, spacing, margins, and contrast.



Font Settings

You can set different fonts for titles and body text. If any fonts are missing in the selected title or body text, the 'Supplementary Font' will automatically replace them.

Custom fonts can also be imported

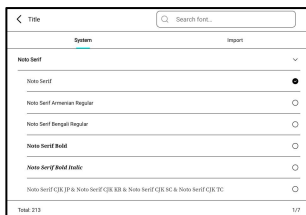

by placing font files in the directory of Storage/fonts. You can view the custom fonts from the imported list.

Refresh

The black and white models support HD, Regal and Balanced refresh modes

The color models support Regal and Balanced refresh modes

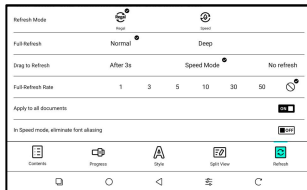

Full refresh (Deep) : When pages with many images and darker backgrounds, this feature helps reduce ghosting during page turns.

6.8 Settings

Please go to reading menu / More / Settings for more settings, including Global Settings, PDF Settings, Touch Settings, Annotation Export Settings, Screenshot Settings, Floating Toolbar Settings, Dictionary Settings, Other Settings, and Version Number.

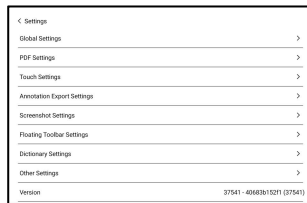
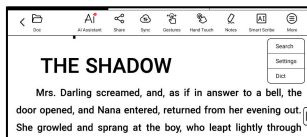

7. Store

In the language of non-Chinese, the Store is offering free publications E-books from the Internet.

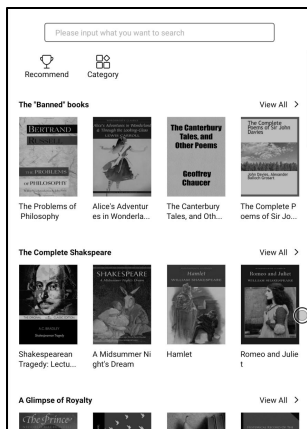

Book Detail

Click a book cover to open up book detail. The specific book information. Click “Full Edition Download” to download the book, then you can see this book cover in Library .

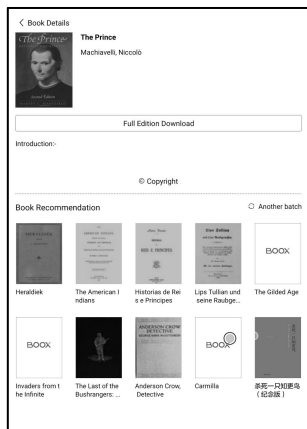

8. Notes

Local Notes: all notes created locally in the Notes app.

Reading Notes: notes created from Split View in the NeoReader app.

Recent Notes: Notes are sorted by Time Updated

Favorite Notes: Include all notebooks marked as Favorites (A ☆ icon shown on the notebook cover)

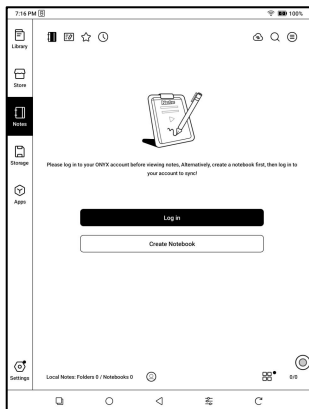

If you already have an ONYX Account and note files, please log in and sync your existing notes before creating new ones.

8.1 ONYX Sync

After Onyx account is logged in, the sync function is on by default.

Notebook lists and notebook content are synced separately.

If a notebook contains a large amount of handwritten data, the sync process may take longer.

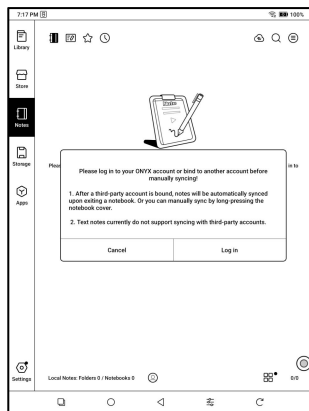

It is recommended to wait for the sync to complete (Indicated ✓ on the notebook cover) before opening the notebook. Check synced notes at BOOX Assistant app or Website push.boox.com.

8.2 Dropdown Menu

The menu includes creating New Folder, Options, Sync Settings, Manage in Bulk, Filter and Sort, and Recycle Bin

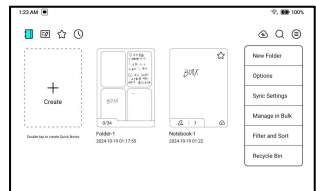

Options

The General settings include Stylus Calibration, Backup and Restore, Password Settings, Handwriting Recognition Language Settings, etc.

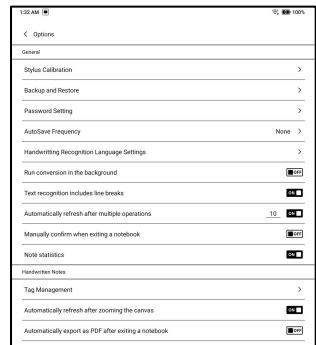

Automatic recognition in the background

When notebooks contain a large amount of handwritten content, enabling “Automatic recognition in the background” can reduce the time needed for initiating AI Recognition manually and for converting handwriting into text.

Password Settings

This password is for the Notes app and can only be used when opening a notebook. It does not sync along with notebooks

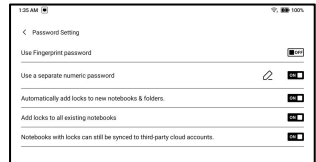

When using a separate numeric password, you can choose to add locks to new notebooks automatically. If you untick this option, the newly created notebook will not be locked with the set password. You need to add the lock manually.

When a notebook is protected with a password, its cover does not show a thumbnail view of your notes.

You can long press a notebook cover to pop out Options to add a lock to the notebook or unlock it.

Sync Settings

ONYX Sync

After you log in to Onyx account, the notes will be automatically synced to Onyx Cloud when you open and close a notebook.

Or you can tap the Sync icon on the Toolbar to manually sync notes.

If you do not want the sync function

You can turn it off from Sync Settings.

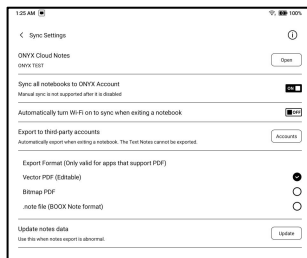

Export to Third-party Accounts (Export)

After third-party notes or cloud storage accounts are bound, the notebook will be automatically exported upon exiting. The third-party sync is one-way, allowing you to export as PDF or PNG to third-party accounts. The exported notebooks cannot be synced back to BOOX Notes.

Currently, the Text Notes cannot be exported.

Sync status

You can long-press the notebook covers to view the sync status. For accounts with sync issues, you can tap the sync icon to manually sync again.

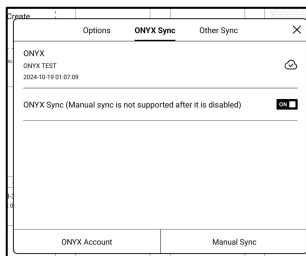

8.3 Create New Notebook

When creating a new notebook, you can select from different notebook types, including Handwritten Notes, Text Notes, Import from local file, and Quick Notes.

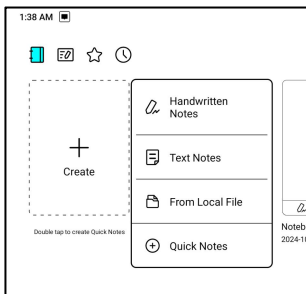

Brush

You can add up to 5 pinned brushes for quick switching between brushes. Tap currently in-use brush to expand settings, allowing you to modify the brush type, color and line width.

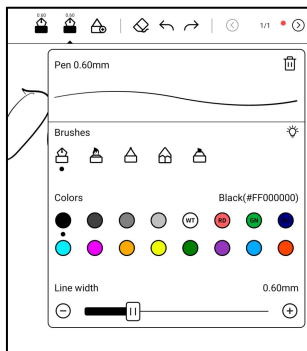

Eraser

The Stroke Eraser is used by default. When using either Stroke Eraser or Mobile Eraser, you need to manually switch back to Brush to continue writing. When erasing current layer or all layers, it will automatically switch back to Brush.

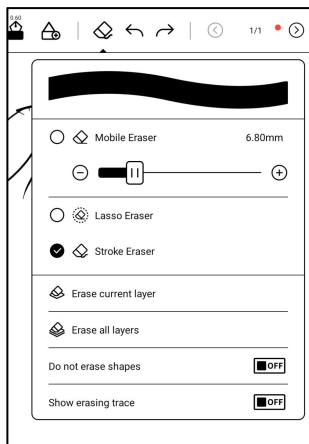

Template

After selecting a template, you can choose to apply it to the current page or all pages.

You can import PDF page(s) or images from local storage to the template library, then use them as templates.

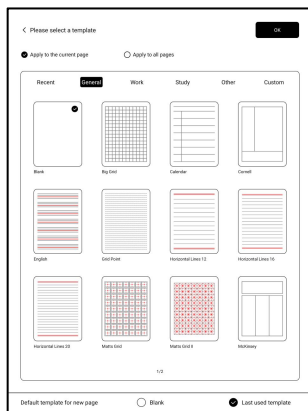

Import PDF templates

You can only select individual pages from a PDF to insert as note template. If you want to use all pages of a PDF in your notebook, please select the option to import the entire PDF document when creating a new notebook.

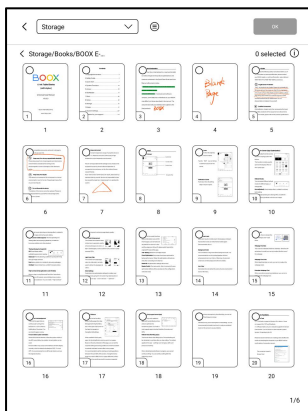

Layers

This supports a template layer and 5 custom layers. You can hide, lock layers and adjust the layer orders. The hidden layers will not be shown in an exported document and will not be recognized by AI Conversion. When a layer is locked, it does not support any editing.

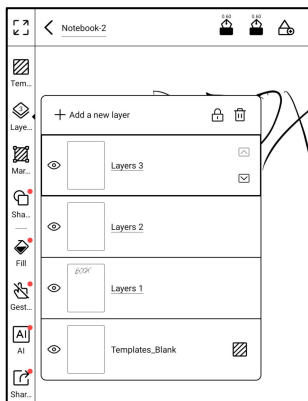

Margins

The note page size matches the screen dimensions by default. Now you can customize page size and add margins. Each page can have different-sized margins.

When resizing from a larger to a smaller page, any strokes outside the new dimensions will not display but will remain intact. They can be visible again when you switch back to the large page size.

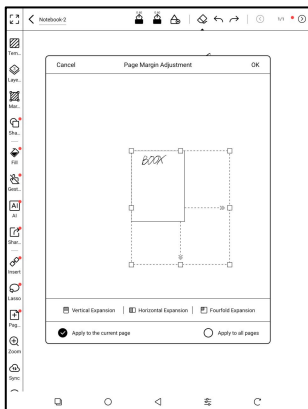

Shapes

Support more than 20 preset shapes, along with various line styles, width, colors, and color fill options.

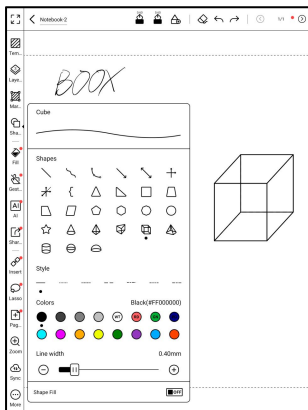

Fill Colors

You can fill enclosed areas with colors.

It can fill colors in an enclosed area.

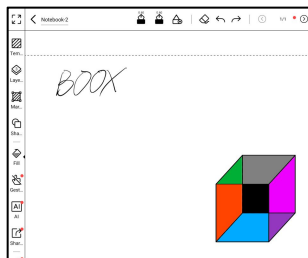

Gestures

To avoid interference with handwriting caused by accidental triggering of edge gestures when your palm moves along the edge of the screen during writing, you can disable certain gesture functions in the Toolbar-Control.

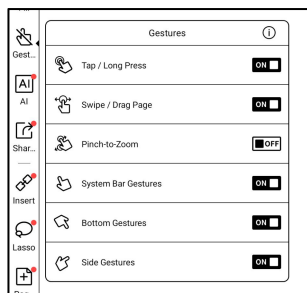

For models with physical buttons, the button function can also be disabled. Please refer to the specification of the product.

Smart Scribe

You can convert hand-drawn shapes into standard ones, use Lasso Recognition, Scribble to Erase, convert handwritten content to editable text.

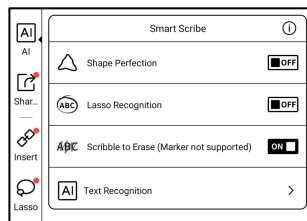

Shape Perfection

Pause for 1 second on the screen after completing the shape drawing, then lift the stylus after the shape is perfected.

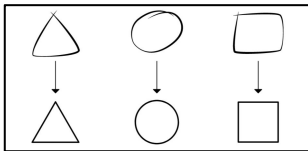

Lasso Recognition

Draw a circle around any handwritten content without pausing. The circle will be converted into a lasso selection. It is not applicable to a blank area.

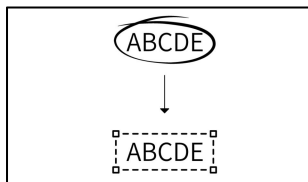

Scribble to Erase

Quickly scribble on any handwritten content, the content will be erased after you lift the stylus. It is not applicable to a blank area.

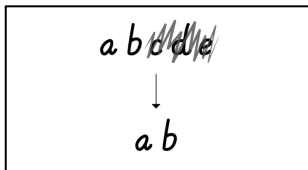

Text Recognition

Convert handwritten notes into text. English and Chinese are available by default. Other languages require language package download.

The converted text can be directly inserted into the current page.

You can choose either original layout or reflow layout to convert all handwritten notes on the current page.

AI converted content is synced based on the original handwritten content. If handwritten content is changed, the content will be re-converted when you start another conversion.

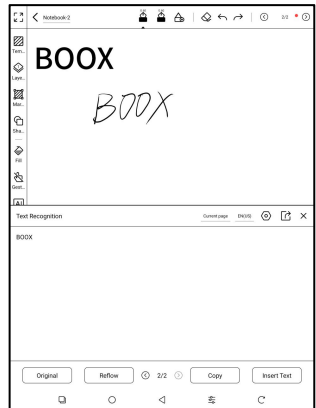

Share and Export

You can select specific pages within a notebook to share and export.

Alternatively, you can long-press on the notebook cover, then choose to share and export. This option does not allow you to select specific pages. You can only share and export the whole notebook.

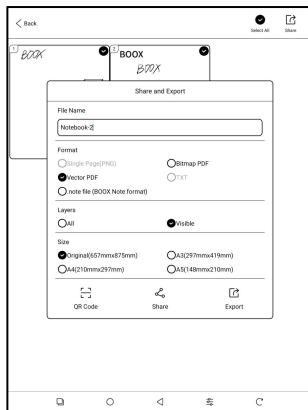

You can export notebooks in .note file, the exclusive format to BOOX Notes app. You can import them to Notes app on other BOOX devices and continue editing.

Import .note notes file

In the Storage, you can tap on a .note file to import it as a new notebook, which can be further edited.

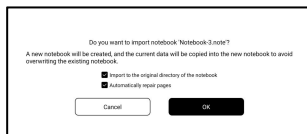

When importing, you can choose whether to keep the original directory of the notebook. It is recommended to choose "Automatically repair" to ensure that the imported data is displayed correctly.

Insert text

You can insert a Text Box by selecting Text icon from the Toolbar, then tap at the desired location on the canvas. Alternatively, you can long-press on a blank area of the canvas, choose Text Box to insert a text box.

Long press the Text Box or use lasso tool to select the Text Box to enter editing status.

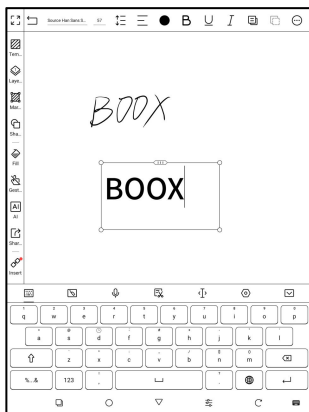
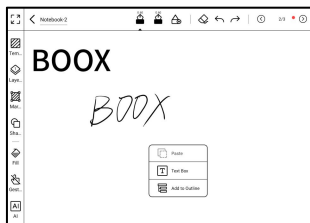

Insert Recorder

Tap Recorder icon on the Toolbar to start recording. Each notebook supports creating multiple recordings.

Recording marks

During playing a recording, you can tap on a specific mark to jump directly to that position to play.

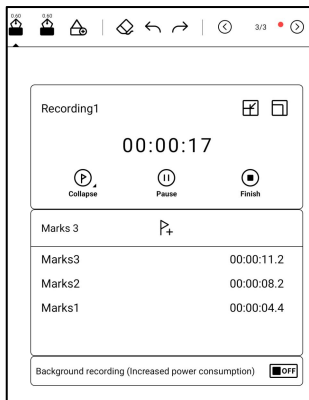

Recording Files (Export)

You can view all recordings associated with the current notebook by choosing Recordings on the Toolbar. You can select individual recordings and export them as MP3 files.

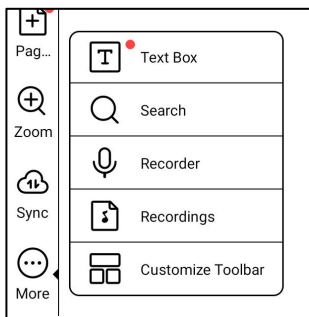

Insert attachment

Here you can insert Images, Attachments, Link to Notes, Link to Files, Link to Website, and Timestamp.

Insert pictures

After inserting images from local storage, you can move, zoom, perform AI Recognition, crop, and copy the images. You can enter the image editing status by using the lasso tool or long-pressing on the image.

Insert attachments

Insert an attachment up to 20MB. The inserted attachments can be synced to Cloud along with the notebooks.

Link to Notes

You can insert a whole notebook, or specific note pages from other notebooks.

Link to Files

You can insert other files or specific pages from other files.

Timestamp

You can choose from different timestamp formats to add to pages.

Lasso

Smart Lasso

Intelligently expand to select the complete stroke range.

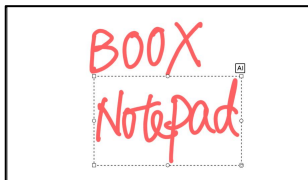

Free Lasso

Retain the actual selection area

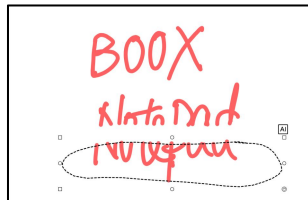

Add Page

You can choose to insert a new page before or after the current page or to the end.

You can directly choose different templates for the new pages.

Alternatively, you can select pages from other notebooks, images, or other files to add.

Add Tags

You can use the Lasso tool to select any notes and add tags, which can add identifiers to the selected notes for search recognition.

Each selected content can be added up to 5 tags. Images, shapes, recordings, and other attachments do not support adding tags.

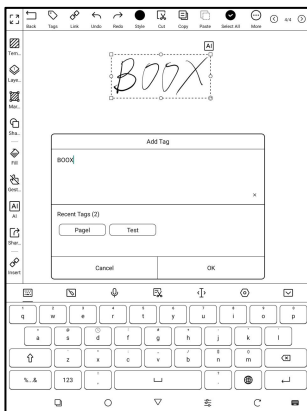
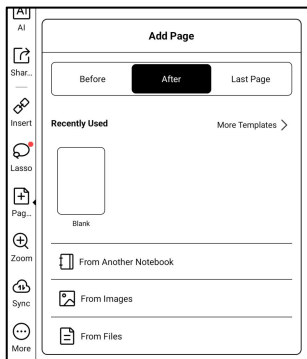

Search tags

The search list shows all tags by default. You can view certain tags by filtering.

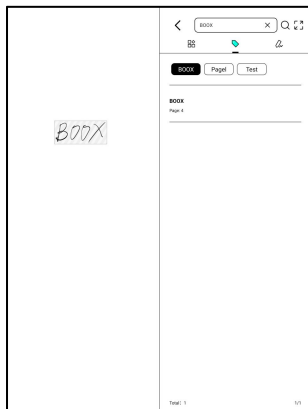

Add Outlines

Long press on a blank area of a notebook, then select Add to Outline from the pop-up menu. The current page can be set as an outline page, allowing you to create outlines for the notebook.

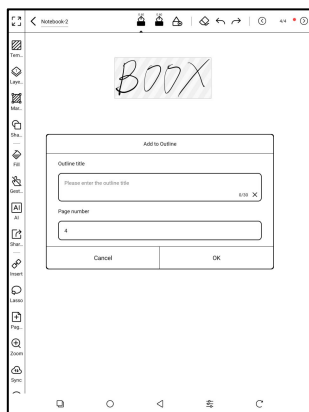

Tap Page Number in the up-right corner to enter Thumbnail interface where you can view the outline structure. In the Outline, you can continue editing and adding sub-outlines. An outline supports up to 5 levels.



8.5 Text Notes

Text Notes supports text input and allows you to adjust formatting, insert recordings, attachments, and perform other operations, but it does not support direct handwriting input using a stylus.

When creating a text notebook, you can choose a template. Within the notebook, you cannot select or modify the template. If you need to adjust the template, it is recommended to clear the formatting using the "Clear Format" option in More menu, and then manually set the desired style.

A single text notebook supports up to 5000 English words.

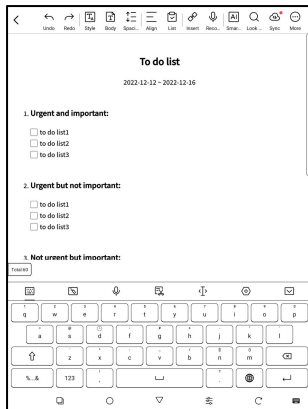

8.6 From local files

You can import local files directly into the Notes app. The supported formats include PDF, CAJ, ePub, Mobi, TXT (below 10MB), and PNG\JPEG\JPG. Currently, the password-protected PDF files are not supported.

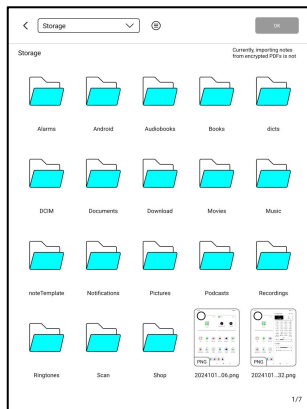

You can use the pages of imported files as templates for notebooks. And you can change them.

Please be aware that once the imported file's page is replaced with a different template, it cannot be restored to its original page. So please proceed with cautions.

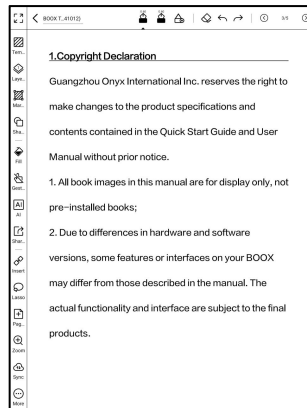

9. Storage

9.1 Recent Files

Here includes Shortcuts and recent files. The recent files are sorted by time in descending order by default and grouped by date automatically.

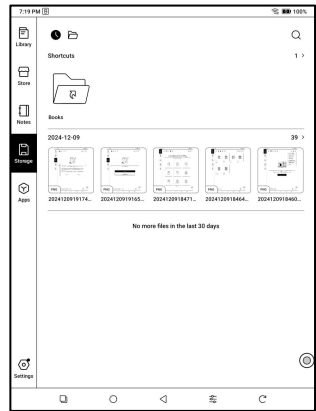

9.2 Storage

Here includes the storage path and document categories. All files are sorted automatically into different categories by type, but the files' original storage location does not change.

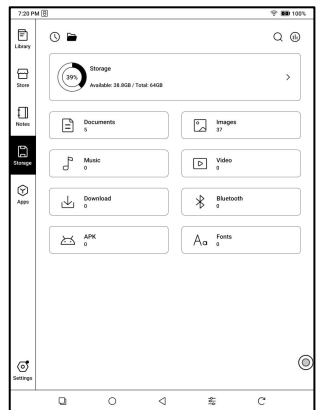

9.3 OTG External Flash Drives

This device supports Type-C OTG flash drives. After a flash drive is inserted, the flash drive will be automatically recognized and loaded as a storage. OTG devices require a power supply and will increase battery consumption

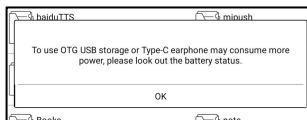

9.4 Low storage warning

Please make sure of leaving at least 300MB of storage for normal system running and relevant data storage. When the storage is lower than 300MB, the system bar will show a warning icon for “insufficient storage” .

10. Apps

10.1 NaviBall

Tap the NaviBall to expand or contract it. Its default display style is fan-shaped. You can change to other styles (Horizontal Style and Vertical Style) from the settings. You can also set its opacity by percentage. You can pin any buttons which will always show on the top.

You can customize each button's function. The available functions include some system functions, switching apps, and app optimization.

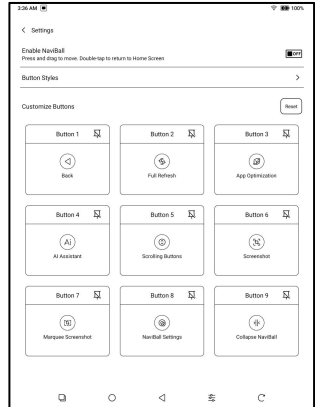

10.2 Dictionary

When you open Dict App for the first time and there is no dictionary installed, there will be a notice to lead you to local downloads, which require a Wi-Fi connection. Word pronunciation requires dictionaries with voice files and TTS is currently not supported.

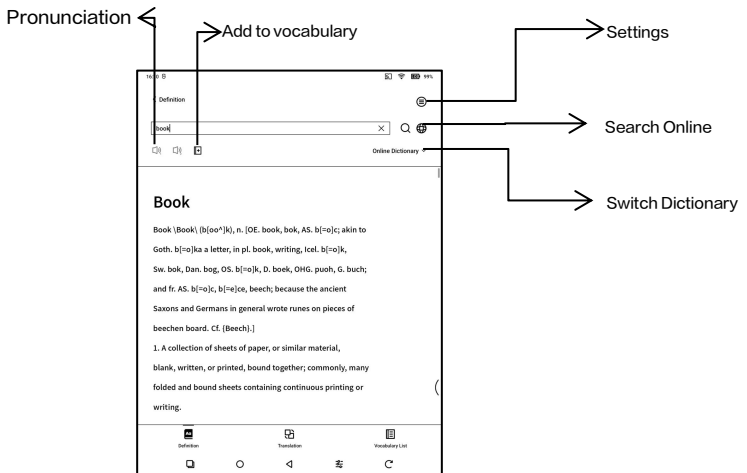

You can import your own dictionary files and save them to the designated storage path:
sdcard\dicts\XXX;

In dictionary Settings/Preferred Dictionary Setting, you can check all available dictionaries. Up to 20 dictionaries are supported.

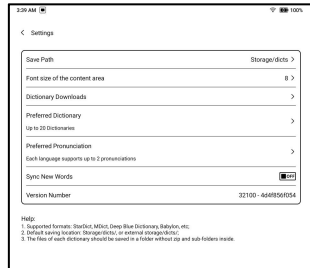

10.3 BOOXDrop

Connect your BOOX with a PC or a mobile phone. You can send files to your BOOX from PC or BOOX Assistant app or saves files of your BOOX to your PC or mobile phone.

How to:

1. Open BOOXDrop from Apps page or Control Center.
2. Open a browser on your PC
 - 2.1 No login required: Make sure your BOOX and PC in the same network. Enter the IP address shown on BOOXDrop interface to your PC browser to connect.

BOOXDrop does not disconnect automatically. If you want to disconnect it, please disconnect it manually or on BOOXDrop interface.

- 2.2 Log in to Onyx Account: open push.boox.com. You can see the connected devices and click any device to open.

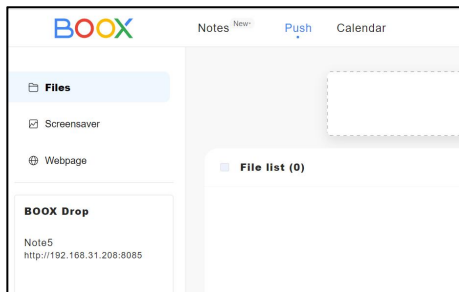

3. When you open a connected device, it will automatically recognize whether your BOOX and your PC are in the same network. If they are not in the same network, you cannot open the page. Please change to the same Wi-Fi.
4. When the connection is successful, you can load all folders and files from your BOOX.
5. Send files to BOOX: You can select files on your PC and send to BOOX. All sent files are grouped into corresponding folders based on file formats.
Recent files: all files are sorted by time and same as Storage/Recent Files
Library: Books/xxx.epub (including all supported file formats)
Image: Pictures/xxx.png
Music: Music/xxxx.mp3
Audios: Movies/xxxx.mp4
Download: Download/xxx.xxx (Including non-books, pictures, mp3, mp4, etc.)
Storage: Send files to the selected storage.

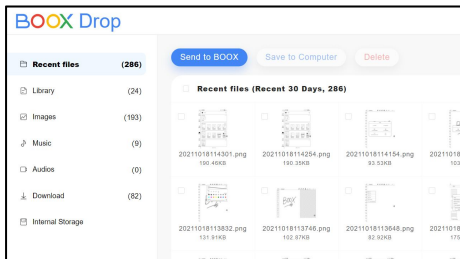

6. Save files to PC: when you select a file from your BOOX on your PC, you can choose a saving path to save to your PC.

10.4 PushRead

Aside from Onyx Push, you can use RSS and OPDS in PushRead.

Onyx Push

You can push webpages to your BOOX via Push in push.boox.com or BOOX Assistant and read on your BOOX. If you use PushRead for the first time, you need to log in to the same Onyx account on both push.boox.com or BOOX Assistant and your BOOX.

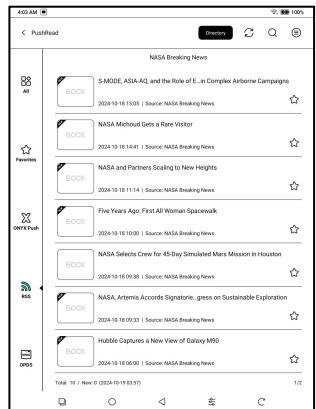

RSS\OPDS Subscription

You can add Subscription from the Directory dropdown menu. In the Public Source list, select the desired subscription source, or you can manual input other valid RSS/OPDS address in the Custom field.

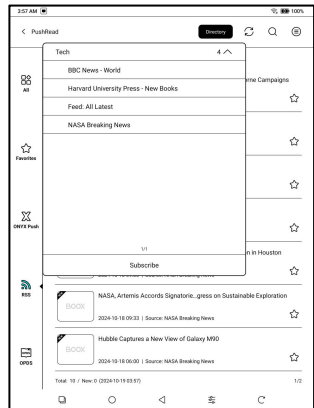

The webpages in PushRead requires internet to load for the first time. After being loaded, it can be read offline.

The default layout is Web Mode (the original webpage 's layout). Tap the center of the screen to bring out the menu where you can switch to Reading Mode, change font size, and fully refresh the screen.

10.5Calendar Memo

In Calendar Memo, it shows Today's Notes and Today's Read. Tap to open notes or books. You can add memo to each day and set the memo as screensaver. Please refer to Screensaver / Calendar Screensaver for settings. Currently, the calendar memos do not support sync to cloud.

After logging in to Onyx account, you can email memos in PDF to a designated email address.

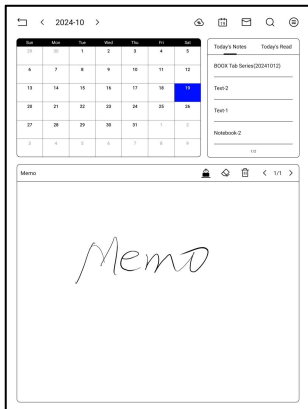

11. System Settings

You can manage multiple accounts and switch them. Select accounts from the list. Only account information is kept and login state is not maintained. After switching to a different account, you need to log in again.

If you log in to different accounts with different servers, please change the server as well when switching accounts.

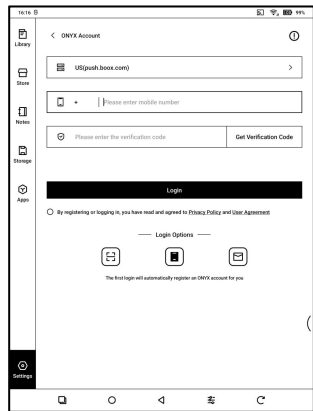

11.1 About Device

It contains model name, Android version, MAC address and firmware version.

Click the model number for more information, including Capacitive Touch Version, Factory Reset, etc.

Note: To run the factory reset would remove all of the user data. Please make a data backup first.

11.2 Languages & Input

Users can set system language, keyboard and input method and TTS on this page;

The system has an Android keyboard by default. Users can install third-party Apps for more input methods.

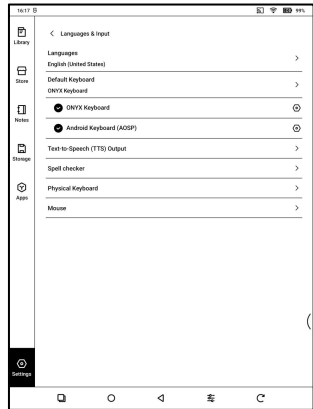

11.3 Date & Time

Users can choose either auto setting or manual setting for date and time. When the device is connected with internet, it will automatically set date and time according to local time zone.

Manual setting requires to set time zone, date and time, and users can select their preferred time and date display format;

11.4 Power

This includes battery usage information, auto sleep and shutdown time settings, delays in disconnecting wireless connection...etc.

If you want to continue using Bluetooth devices to play online audio content after the device enters Sleep mode, please turn on the WiFi, Bluetooth, and audio switches after Auto sleep;

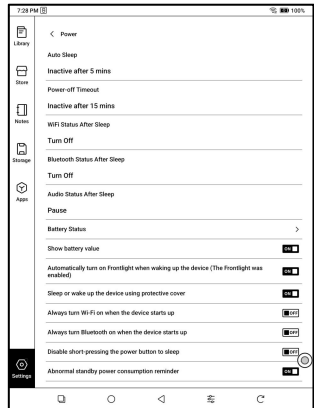

11.5 Network

This is for Wi-Fi \VPN\Bluetooth setting. When Wi-Fi is connected, users can browse webs and download books via the internet on the device.

Wi-Fi Settings

Slide Wi-Fi On, then available networks will be listed. Users can choose a network, then input password to connect with internet.

After Wi-Fi is connected successfully at the first time, the device will save Wi-Fi information automatically. Users only need to turn on Wi-Fi on notification bar if using the same WIFI next time.

Click the “+” button at the top right of the Wi-Fi page, users could manually connect to other network which is not listed, such as 802.1xEAP.

Bluetooth Settings

Turn on Bluetooth, you can search for nearby Bluetooth devices and then send connection requests.

Bluetooth needs to be paired before use. Currently only support the eReader to receive documents, send documents from Boox eReader to other devices is not supported.

VPN Setting

When the VPN is turned on for the first time, the system requires to set a password. This password needs to be used only for screen unlock or when the factory settings are restored.

11.6 Password

You can set 4–16 digital screen–lock password.

The Android 11 models do not support resetting the password, please keep the password properly by yourself.

11.7 System Display

System Font size

Support to adjust the system font size, the default is the standard font size, you can set a total of 4 sizes: small, standard, large, extra–large;

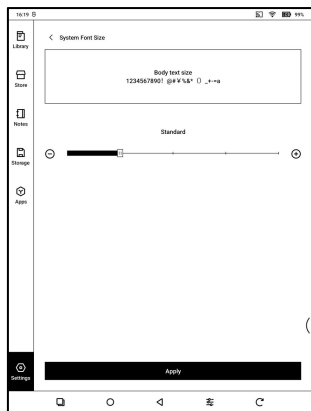

System Fonts

Support importing font files and setting system font.

The font files take up the storage space of the device. So, it is not recommended to import large font packages.

Some third-party font file may have missing characters, which could result in garbled text or display issues. Please ensure the font file is OK before importing and using it.

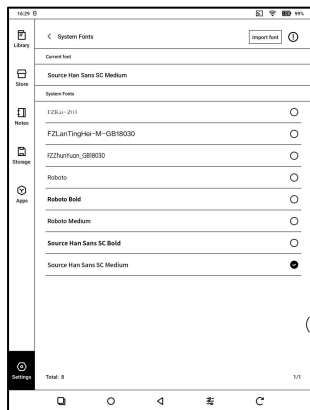

Custom Homepage

The default Homepage is Library. You can set any of the other Function pages as the Homepage. You can return to the Homepage by tapping the homepage icon from the dropdown notification center.

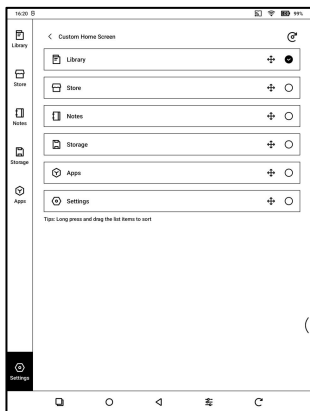

System full screen refresh frequency

The system defaults to a full refresh every 5 or 15 operations to reduce screen ghosting.

The actual number of operations will be one less than the set number;

11.8 Gesture Manager

You can choose system navigation method, either by Gestures or by Navigation Bar. There are 3 bottom gestures and 2 side gestures for Gesture method.

Support modification to other functions;

Side Gestures

The Up-and-down Swipe Gestures are used to adjust Brightness, Volume, etc. by dragging the slider up and down.

The Left-and-right Swipe Gestures are used to perform custom functions by swiping inward from the sides.

This Gesture may overlap with turning pages by swiping left

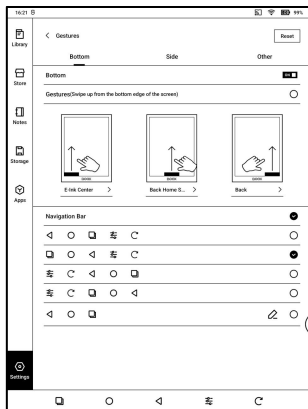

and right. So, it is recommended to choose suitable gestures based on actual needs to avoid affecting the main gestures use.

11.9 System Update

Upgrade checks the local package first then online package with a network connection. Upgrade pause and breakpoint download are allowed.

Please ensure the device has more than 20% power and sufficient capacity before the update.

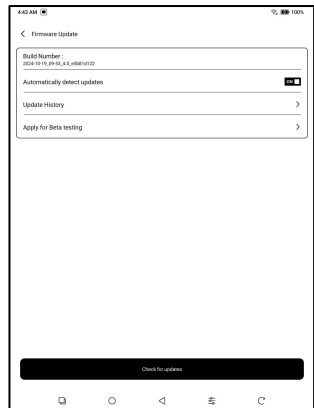

11.10 Feedback

Welcome to submit any technical problem or advice to us.

This function collects system information for problem judgment. And Onyx shall never disclose users' device information.

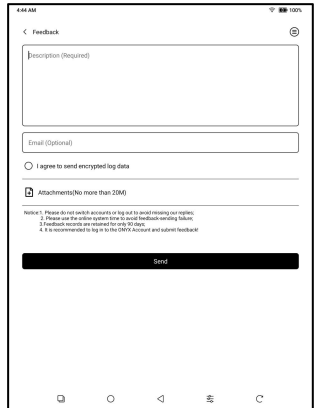

The image shows a mobile application interface for a feedback form. At the top, the status bar displays '4:48 AM' and '100%' battery. The app title is 'Feedback'. The form contains a large text area for 'Description (Required)', an 'Email (Optional)' field, and a checkbox for 'I agree to send encrypted log data'. Below this is an 'Attachments (No more than 20MB)' section with a small icon. A 'Notice' section contains four lines of fine print. At the bottom is a black 'Send' button. The bottom of the screen shows standard Android navigation icons.

4:48 AM 100%

< Feedback

Description (Required)

Email (Optional)

☐ I agree to send encrypted log data

Attachments (No more than 20MB)

Notice: 1. Please do not switch accounts or log out to avoid missing our replies.
2. Please use the system space for the report feedback sending. Thank you.
3. Feedback records are retained for only 30 days.
4. It is recommended to log in to the ONYX Account and submit feedback.

Send

12. Thank you for your support

Thank you very much for your support. More product-related information can be found on our official website:

www.boox.com

If you have any questions, please contact us by email:
support@boox.com